

WBS NO: 50975.3.4

CONTRACT: DC00494

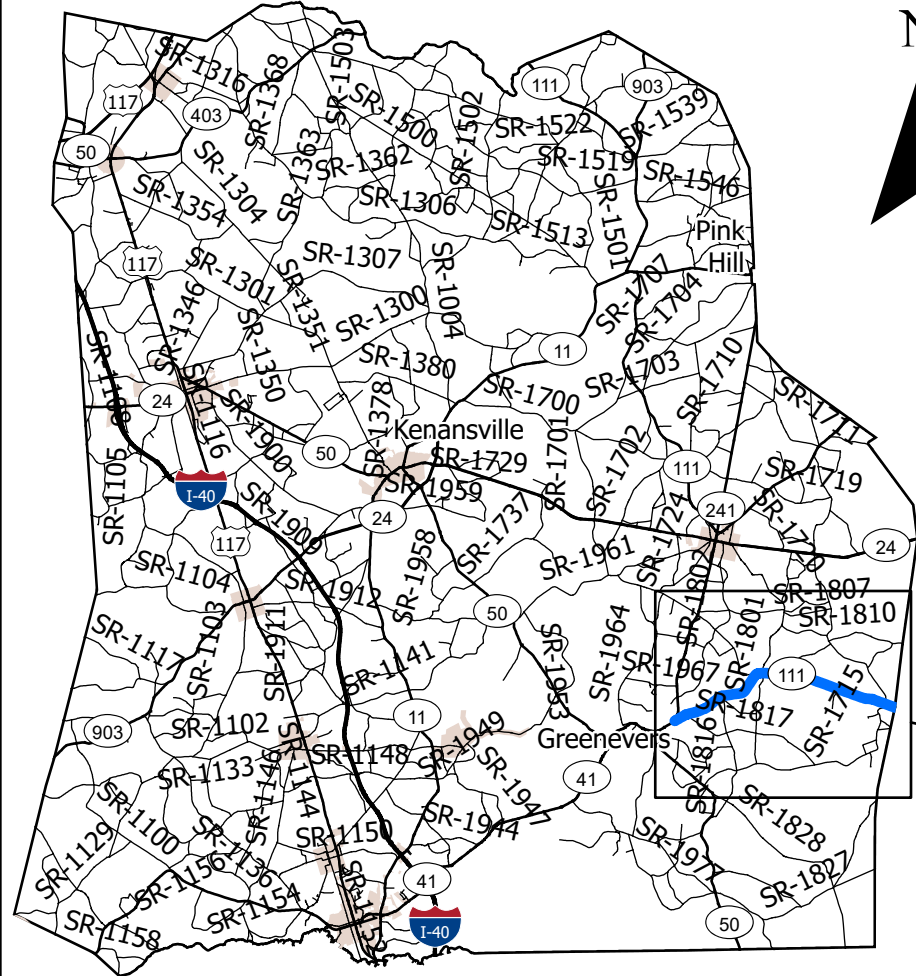

STATE OF NORTH CAROLINA
 DIVISION OF HIGHWAYS
DUPLIN COUNTY

*TYPE OF WORK: WIDENING, RUMBLE
 INSTALLATION & THERMOPLASTIC MARKINGS*

STATE	STATE PROJECT REFERENCE NUMBER	SHEET NO.
NC	HS2403C	1
STATE PROJECT NUMBER		DESCRIPTION
HS-2403C		50975.3.4

CL = Centerline
 SH = Shoulder
 EL = Edgeline

Wide Line

MAP	ROUTE	DESCRIPTION	TYPE
1	NC-111	FROM ONSLOW COUNTY LINE TO NC 41	Wide Line

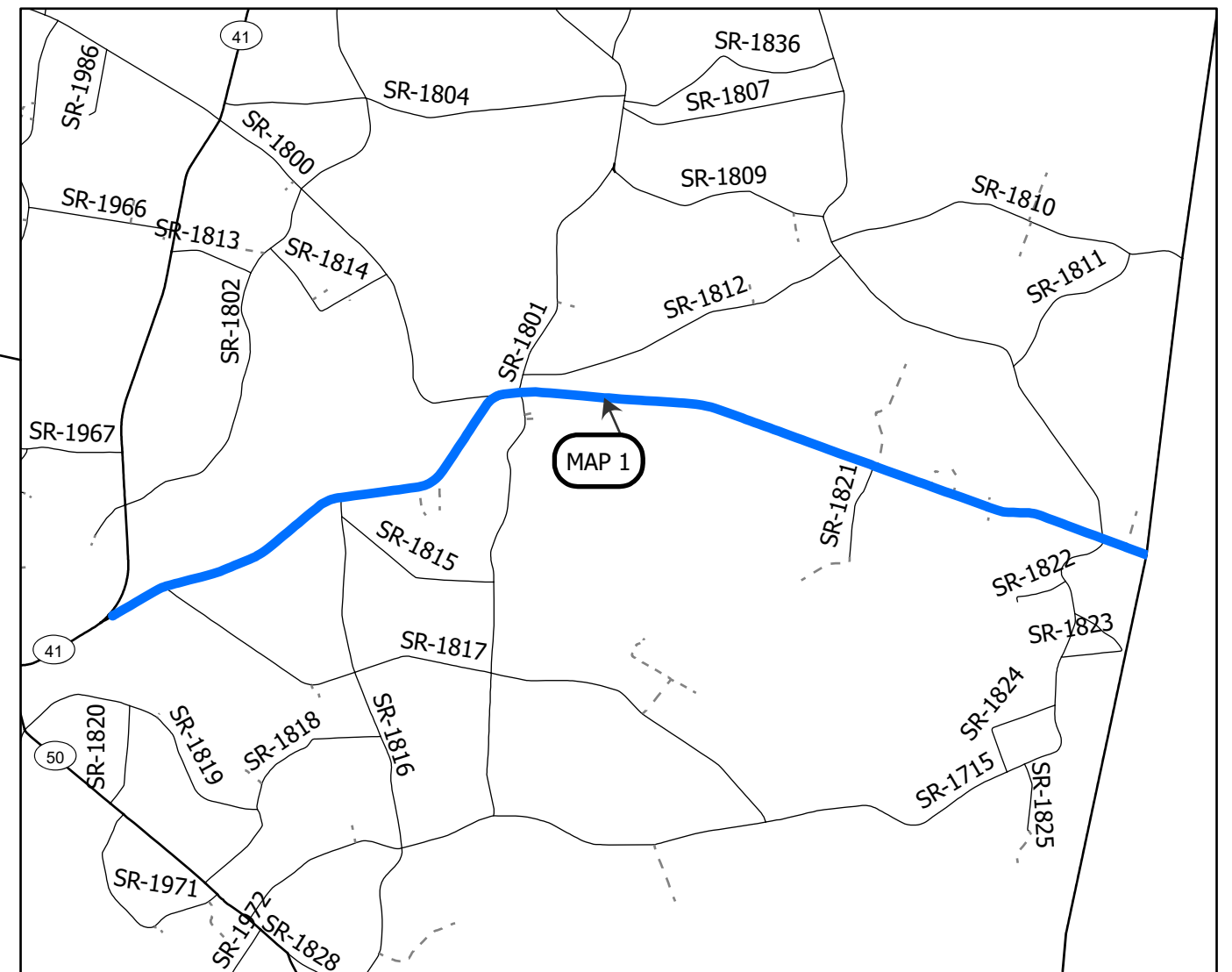

PROJECT LENGTH

MAP	MILES
1	8.42

Prepared in the Office of:
DIVISION OF HIGHWAYS
 5501 BARBADOS BLVD., CASTLE HAYNE, NC, 28429

This exhibit does not meet NC 47-30 requirements and therefore is not intended for design, construction, or recording or transfer of title.



WBS NO: 50975.3.4

CONTRACT: DC00494

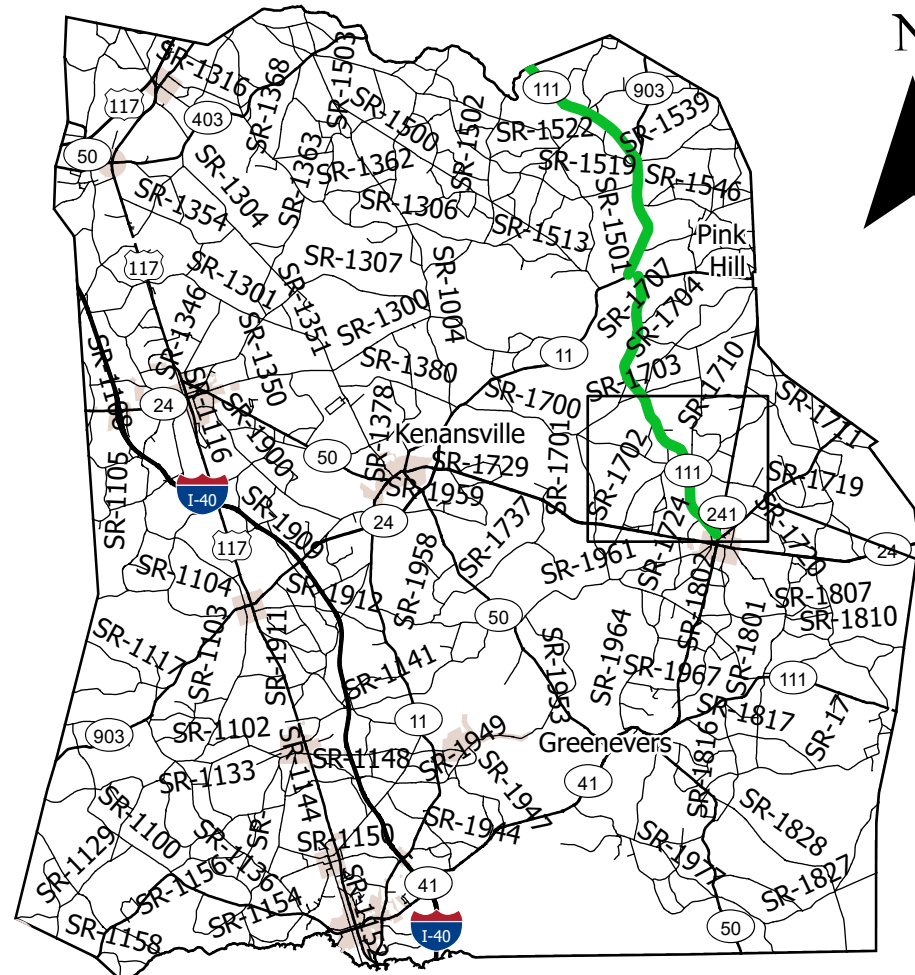

STATE OF NORTH CAROLINA
 DIVISION OF HIGHWAYS
DUPLIN COUNTY

*TYPE OF WORK: WIDENING, RUMBLE
 INSTALLATION & THERMOPLASTIC MARKINGS*

STATE	STATE PROJECT REFERENCE NUMBER	SHEET NO.
NC	HS2403C	2
STATE PROJECT NUMBER		DESCRIPTION
HS-2403C		50975.3.4

CL = Centerline
 SH = Shoulder
 EL = Edgeline

— Rumble Installation
■ Division 3 Bridges

MAP	ROUTE	DESCRIPTION	TYPE
2	NC-111	FROM BEULAVILLE CITY LIMITS TO SR 1703 CABIN ST	WIDENING 14" CL, 8" SH

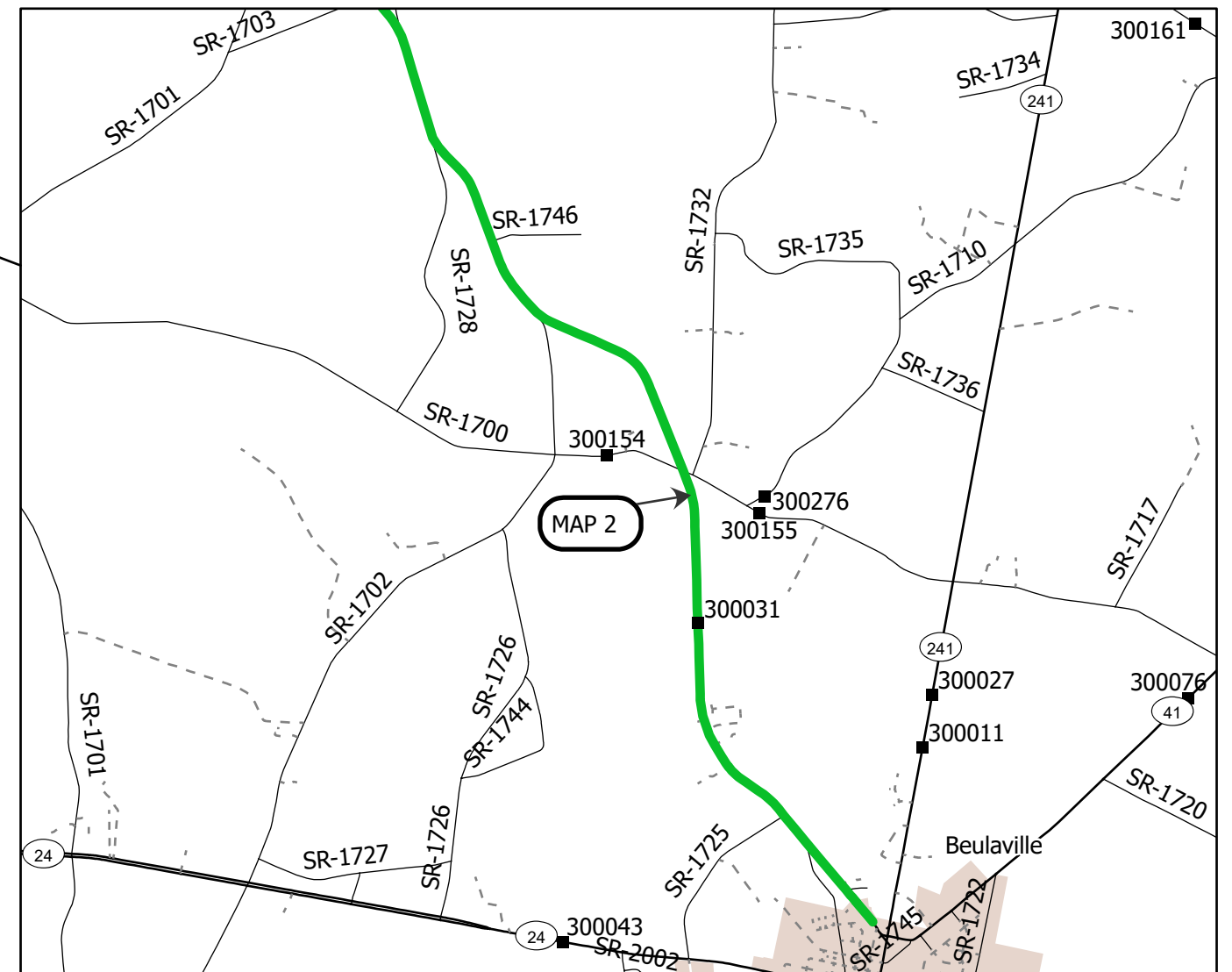

PROJECT LENGTH

MAP	MILES
2	5.80

Prepared in the Office of:
DIVISION OF HIGHWAYS
 5501 BARBADOS BLVD., CASTLE HAYNE, NC, 28429

This exhibit does not meet NC 47-30 requirements and therefore is not intended for design, construction, or recording or transfer of title.



WBS NO: 50975.3.4

CONTRACT: DC00494

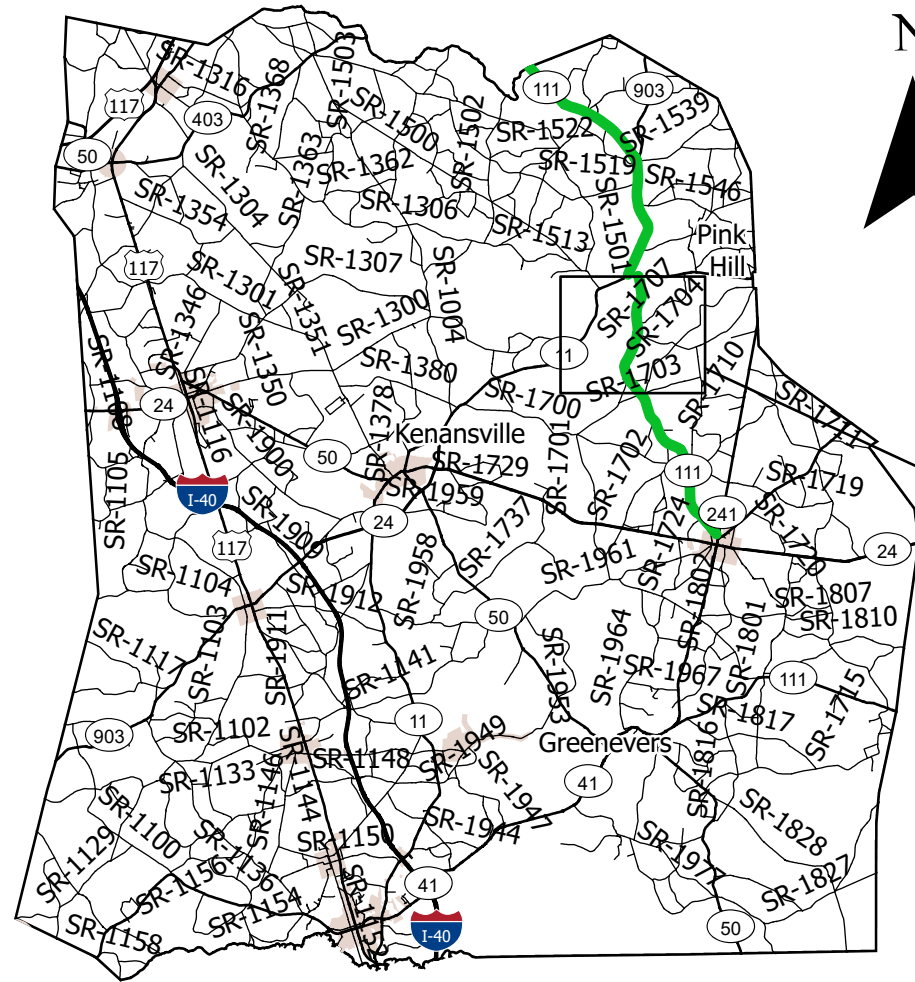

STATE OF NORTH CAROLINA
 DIVISION OF HIGHWAYS
DUPLIN COUNTY

*TYPE OF WORK: WIDENING, RUMBLE
 INSTALLATION & THERMOPLASTIC MARKINGS*

STATE	STATE PROJECT REFERENCE NUMBER	SHEET NO.
NC	HS2403C	3
STATE PROJECT NUMBER		DESCRIPTION
HS-2403C		50975.3.4

CL = Centerline
 SH = Shoulder
 EL = Edgeline

— Rumble Installation
■ Division 3 Bridges

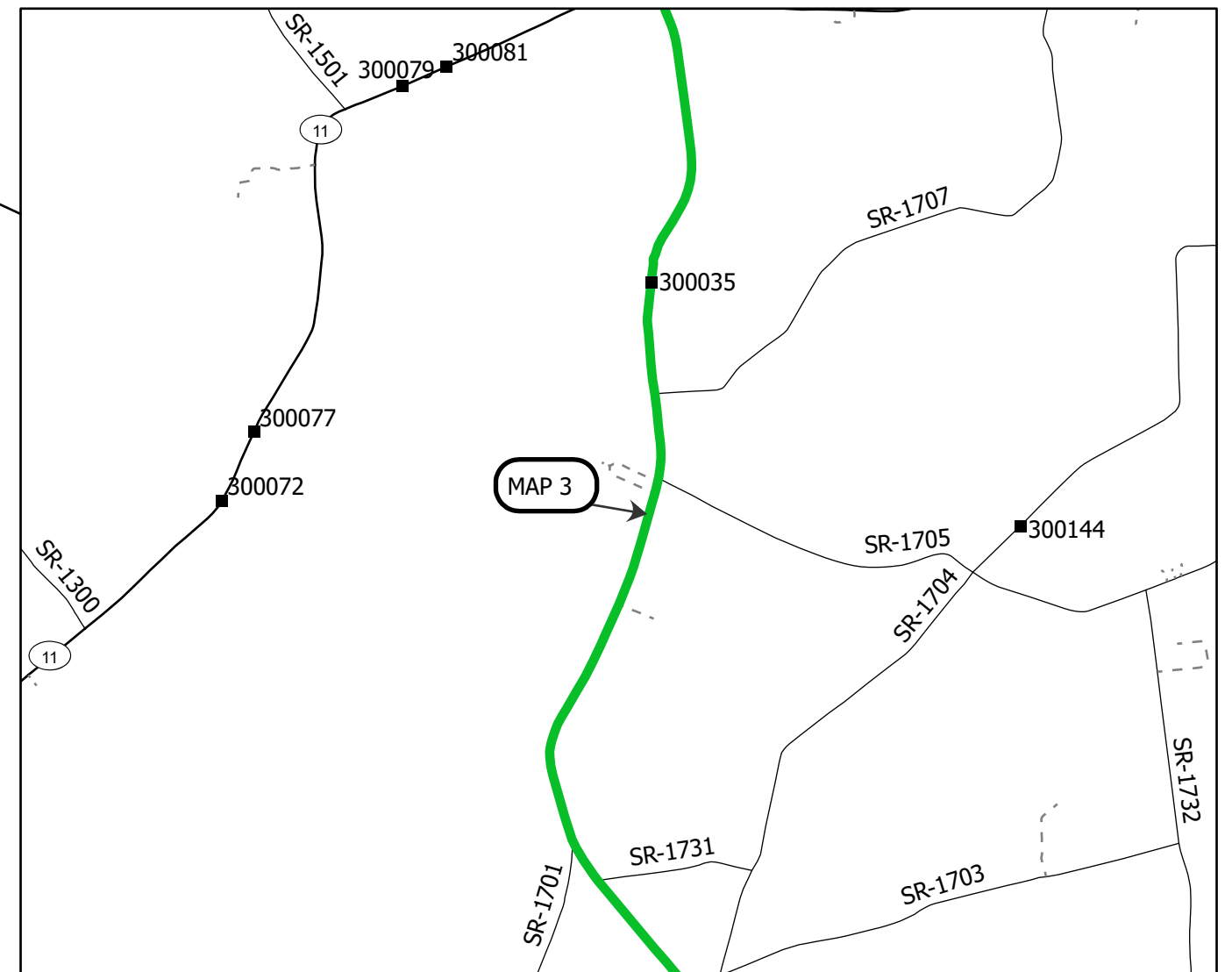

MAP	ROUTE	DESCRIPTION	TYPE
3	NC-111	FROM SR 1703 CABIN ST TO NC 11	14" CL, 8" SH

PROJECT LENGTH

MAP	MILES
3	4.38

Prepared in the Office of:
DIVISION OF HIGHWAYS
 5501 BARBADOS BLVD., CASTLE HAYNE, NC, 28429

This exhibit does not meet NC 47-30 requirements and therefore is not intended for design, construction, or recording or transfer of title.



WBS NO: 50975.3.4

CONTRACT: DC00494

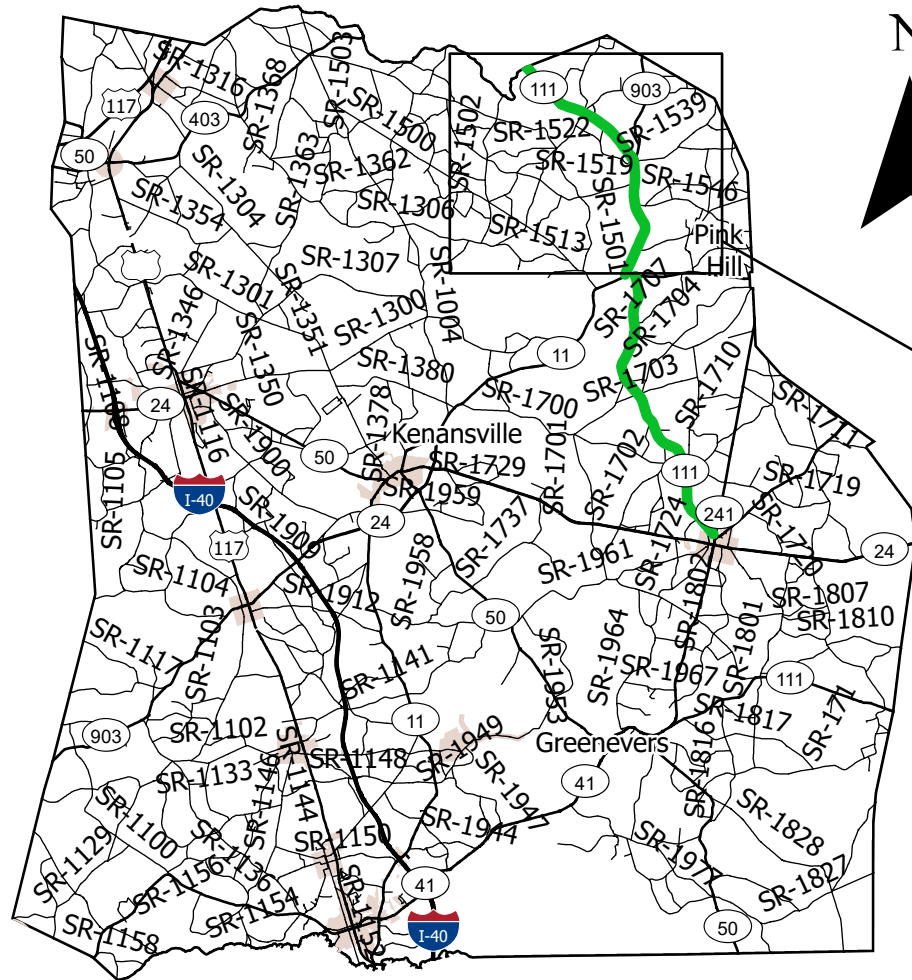

STATE OF NORTH CAROLINA
 DIVISION OF HIGHWAYS
DUPLIN COUNTY

*TYPE OF WORK: WIDENING, RUMBLE
 INSTALLATION & THERMOPLASTIC MARKINGS*

STATE	STATE PROJECT REFERENCE NUMBER	SHEET NO.
NC	HS2403C	4
STATE PROJECT NUMBER		DESCRIPTION
HS-2403C		50975.3.4

CL = Centerline
 SH = Shoulder
 EL = Edgeline

— Rumble Installation
■ Division 3 Bridges

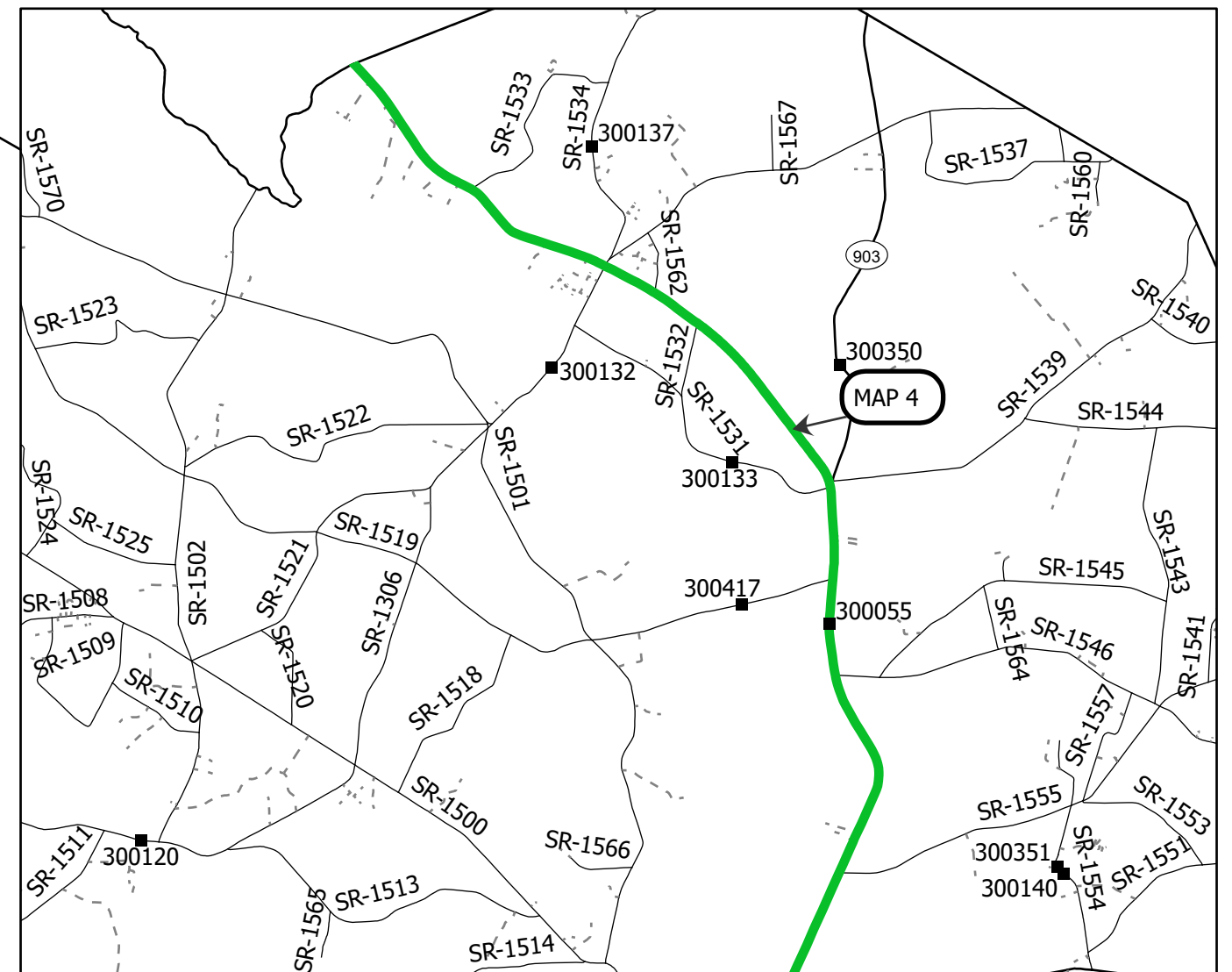

MAP	ROUTE	DESCRIPTION	TYPE
4	NC-111	FROM NC 11 TO WAYNE COUNTY LINE	14" CL, 8" SH

PROJECT LENGTH

MAP	MILES
4	9.24

Prepared in the Office of:
DIVISION OF HIGHWAYS
 5501 BARBADOS BLVD., CASTLE HAYNE, NC, 28429

This exhibit does not meet NC 47-30 requirements and therefore is not intended for design, construction, or recording or transfer of title.



PAVEMENT SCHEDULE

E1	PROP. APPROX. 4" DEPTH ASPHALT CONCRETE INTERMEDIATE COURSE, TYPE I19.0C, AT AN AVERAGE RATE OF 456 LBS. PER SQ. YD.
T1	EARTH MATERIAL (EXISTING SHOULDERS)
V1	14" SINUSOIDAL MILLED RUMBLE STRIPE, CENTERLINE
V2	8" SINUSOIDAL MILLED RUMBLE STRIP, SHOULDER

NOTES: MAP #1 (NC-111) IS 6" WIDE LINES ONLY
 START MILL AT INSIDE OF EXISTING EDGELINE MARKINGS FOR MAP #1
 MAINTAIN EXISTING LANE WIDTHS

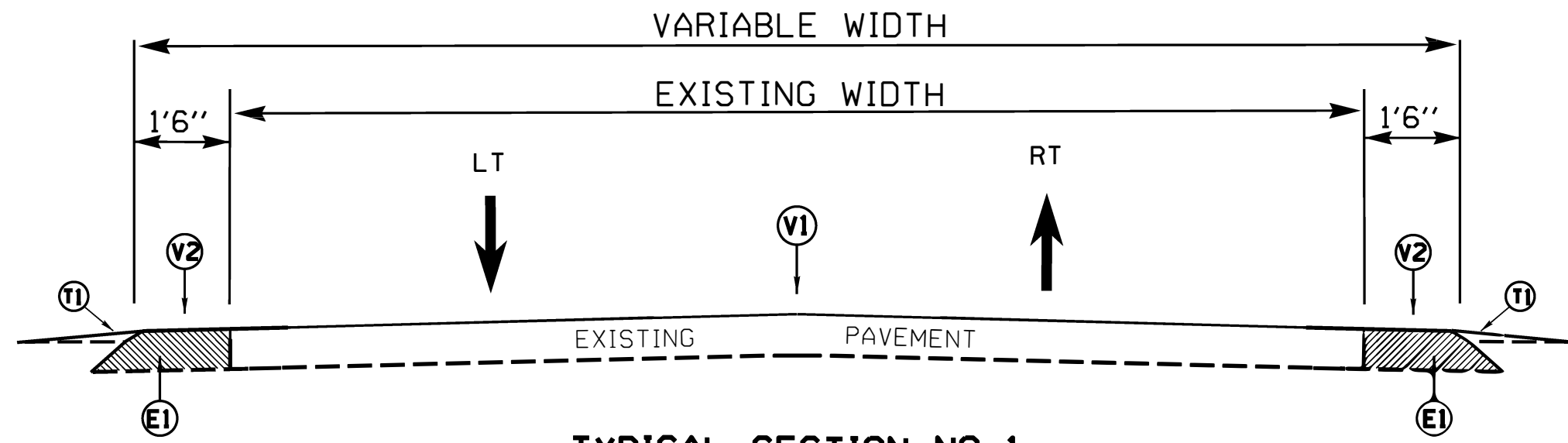

TYPICAL SECTION NO. 1

MAP NO. 2
 NC - 111 (DUPLIN)
 MP 15.20 - MP 17.83

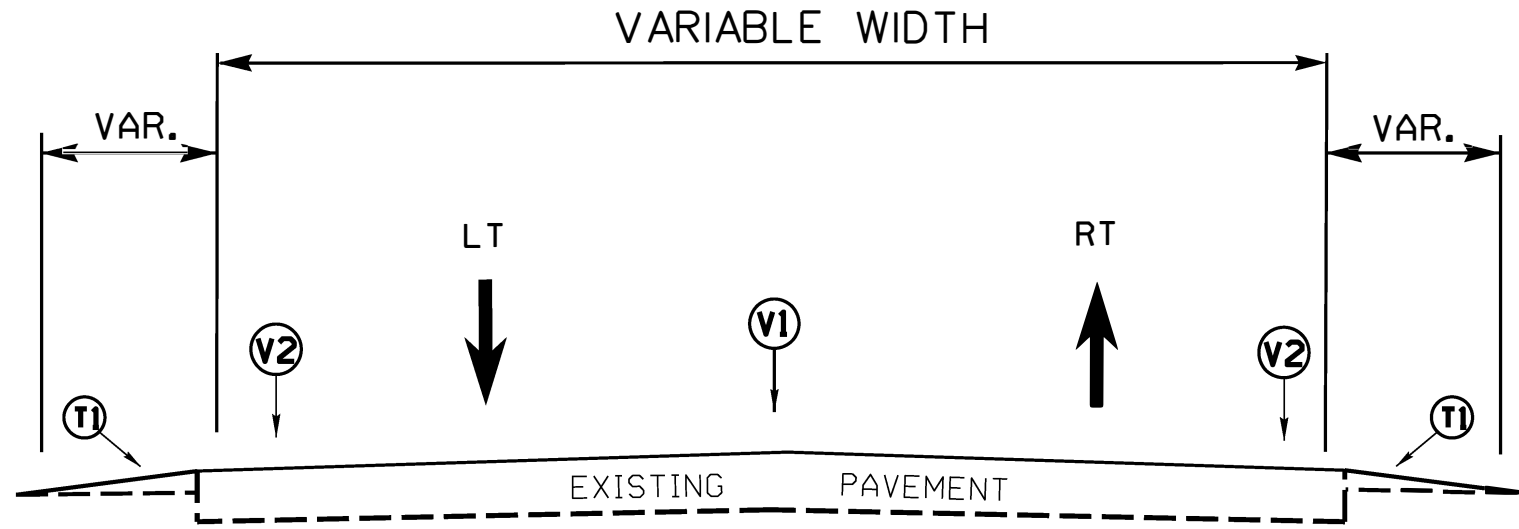

TYPICAL SECTION NO. 2

MAP NO. 2
 NC - 111
 MP 17.83 - MP 21.00

MAP NO. 3
 NC - 111
 MP 21.00 - MP 25.38

MAP NO. 4
 NC - 111
 MP 25.74 - MP 34.98

2024 ROADWAY ENGLISH STANDARD DRAWINGS
 The following Roadway Standards as appear in "Roadway Standard Drawings" Highway Design Branch - N.C. Department of Transportation - Raleigh, N.C., Dated January, 2024 are applicable to this project and by reference hereby are considered a part of these plans:
 STDNO. TITLE
 DIVISION 12 - PAVT MARKING, MARKERS AND DELINEATION
 1205.08 Pavement Markings - Symbols & Word Messages

REVISIONS

8/17/99
 SYSTEMS
 DESIGN
 NAME

STATE OF NORTH CAROLINA
DEPT. OF TRANSPORTATION
DIVISION OF HIGHWAYS
RALEIGH, N.C.

ROADWAY DETAIL DRAWING FOR
RUMBLE STRIPS / STRIPES
SINUSOIDAL SHOULDER RUMBLE STRIP

SHEET 2 OF 9

See Table 1 within Rumble Strip Policy for Design Guidance

PLAN VIEW

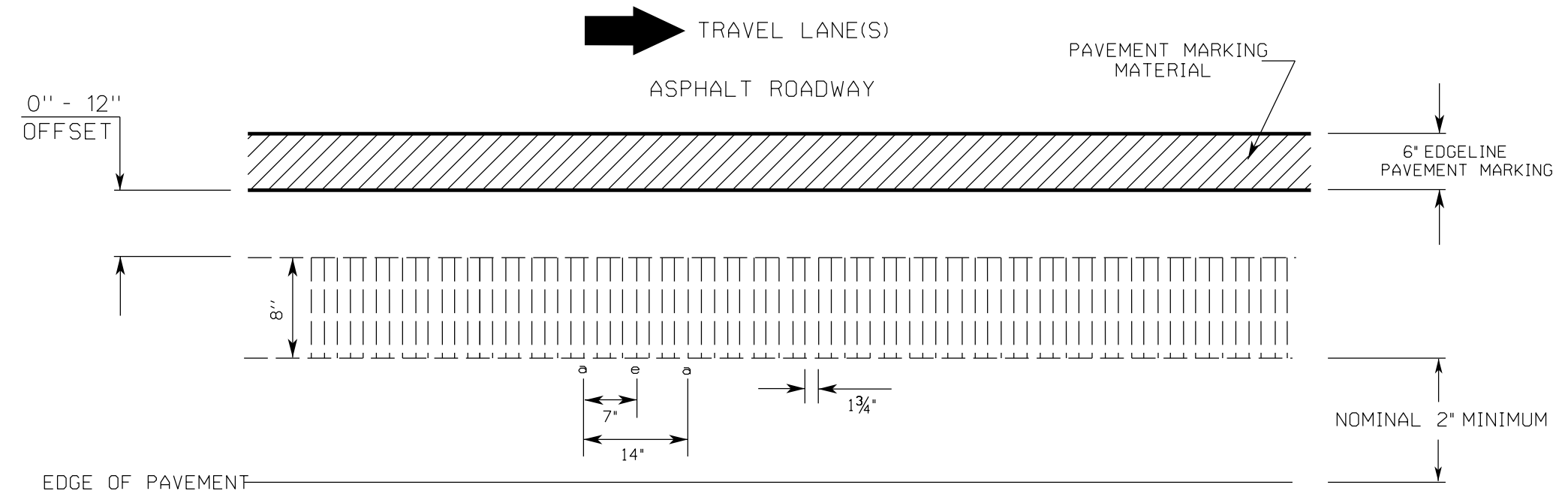

PROFILE VIEW

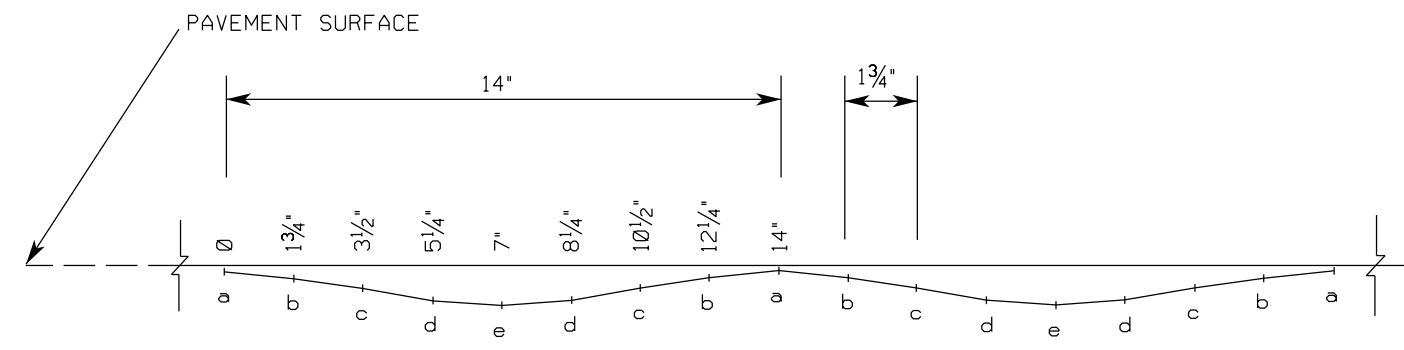

LOCATION	DEPTH	
	MIL	INCHES
a	62.5	1/16"
b	125	1/8"
c	219	7/32"
d	344	1 1/32"
e	375	3/8"

REFERENCE DRAWING ID: Sin.Strip

NOTES:

1) Specification in table taken from MNDOT Research Project Final Report 2016-23: Sinusoidal Rumble Strip Design Optimization Study By: Terhaar et. al, June 2016

DocuSigned by:
Jessi L. Leonard
4D590D07E47C40F...
11/13/2025



CONTRACTS STANDARDS AND DEVELOPMENT UNIT
Office 919-707-8950 FAX 919-250-4119

SEE TITLE BLOCK

ORIGINAL BY: C. SIMPSON DATE: 04-24-2025
MODIFIED BY: DATE: _____
CHECKED BY: DATE: _____
FILE SPEC.: _____

See Table 2 within Rumble Strip Policy for Design Guidance

LANE TREATMENT

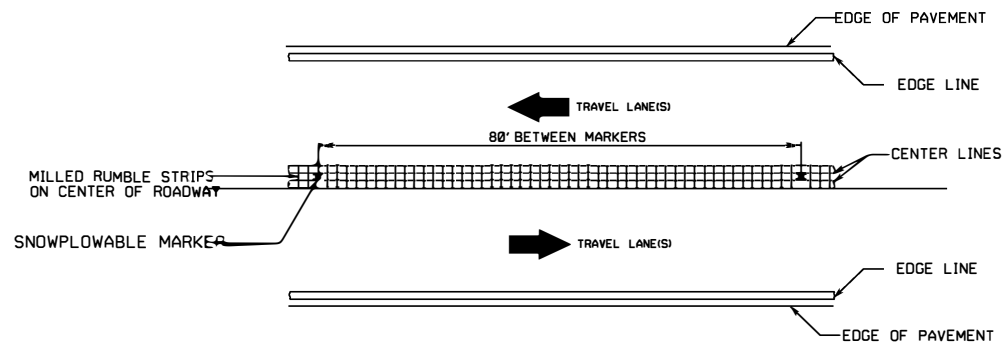

PROFILE:

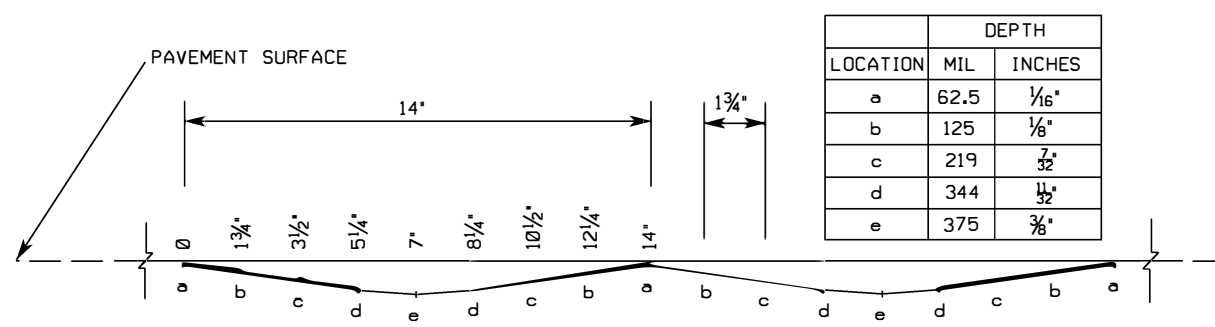

SECTION A-A'

CENTER LINE

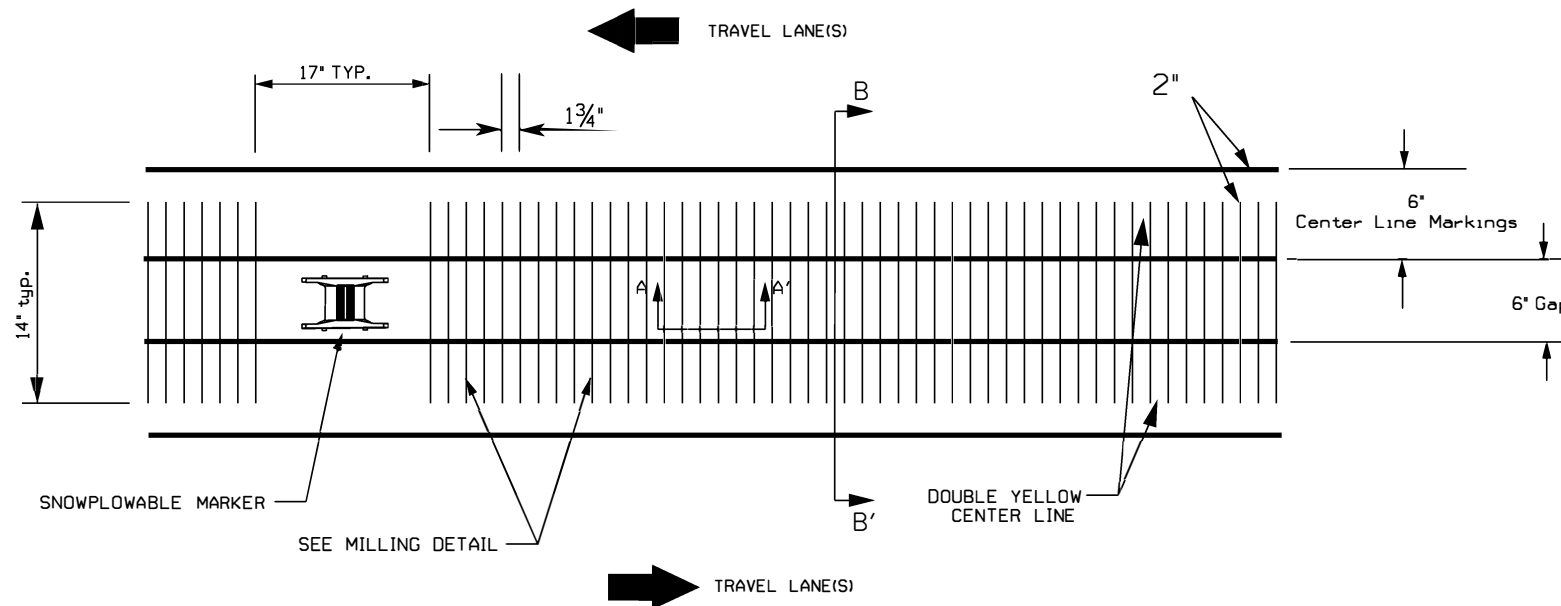

MILLING DETAIL

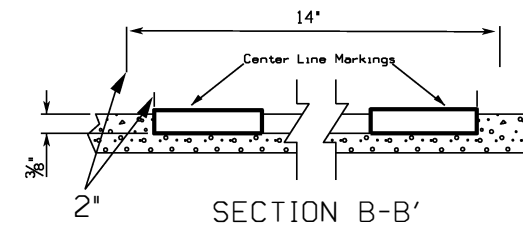

SECTION B-B'

REFERENCE DRAWING ID: S1n.CL with Snowplowable Markers

NOTES:

- 1) USING A VACUUM, REMOVE ALL DEBRIS FROM THE MILLINGS JUST PRIOR TO PLACING ANY PAVEMENT MARKINGS.
- 2) ENSURE GLASS BEADS ARE SPREAD UNIFORMLY OVER THE ENTIRE SURFACE OF THE PAVEMENT MARKING MATERIAL.
- 3) INSTALL SNOWPLOWABLE MARKERS AT APPROXIMATELY 80' INCREMENTS. DO NOT MILL RUMBLE STRIPS IN SECTION WHERE SNOWPLOWABLE MARKERS ARE INSTALLED.

STATE OF NORTH CAROLINA
 DEPT. OF TRANSPORTATION
 DIVISION OF HIGHWAYS
 RALEIGH, N.C.

ROADWAY DETAIL DRAWING FOR
 RUMBLE STRIPS / STRIPES
 SINUSOIDAL CENTERLINE RUMBLE STRIPE WITH SNOWPLOWABLE MARKERS

SHEET 8 OF 9



DocuSigned by:
Jessi L. Leonard
 4D590D07E47C40F...
 11/13/2025

CONTRACTS STANDARDS AND DEVELOPMENT UNIT
 Office 919-707-8950 FAX 919-250-4119

SEE TITLE BLOCK

ORIGINAL BY: C. SIMPSON DATE: 04-24-2025
 MODIFIED BY: DATE:
 CHECKED BY: DATE:
 FILE SPEC.:

SIGNING FOR RESURFACING PROJECTS

LEGEND
 ┆ STATIONARY SIGN
 ← DIRECTION OF TRAFFIC FLOW

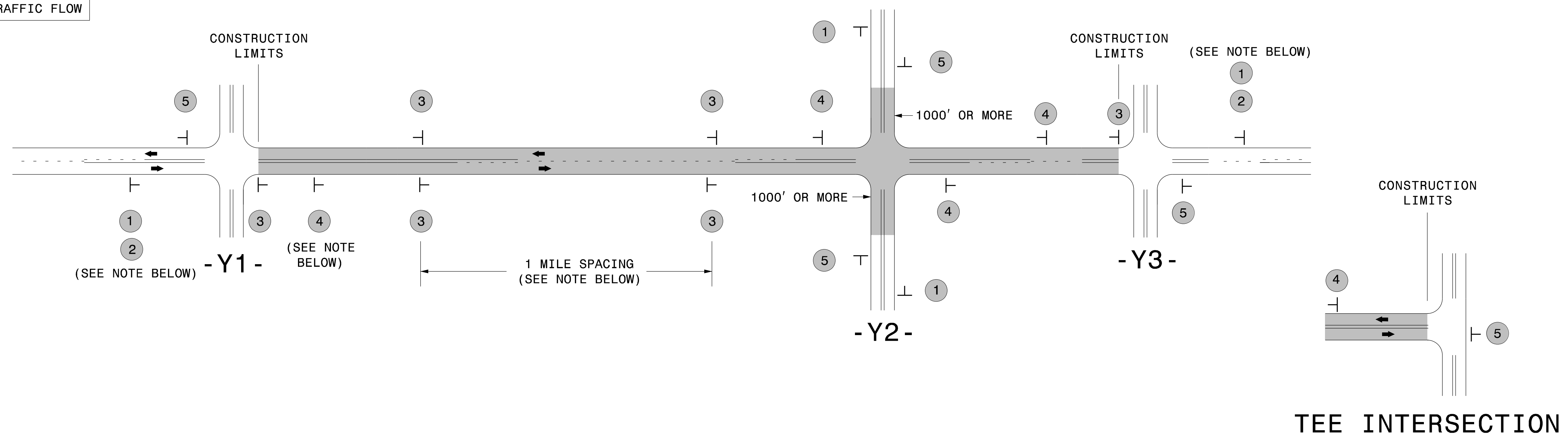

MAINLINE (-L-) SIGNING

-Y- LINE SIGNING

SIGNING NOTES AND PLACEMENT PER DIRECTION	1		PLACE 1000' PRIOR TO BEGINNING OF CONSTRUCTION LIMITS. ONLY USED ON -Y- LINES IF RESURFACING LIMITS EXTEND 1000' ALONG -Y- LINE.	<p>NO REQUIRED STATIONARY SIGNING FOR THE FOLLOWING -Y- LINE CONDITIONS:</p> <ol style="list-style-type: none"> 1) LESS THAN 1000' OF RESURFACING ALONG -Y- LINE 2) SUBDIVISION ROADS 3) DEAD END ROADS <p>WHEN PAVING/CONSTRUCTION ACTIVITIES PROCEED ACROSS AN UNSIGNED -Y- LINE, PORTABLE ADVANCE WARNING SIGNS SHALL BE USED ALONG THE -Y- LINE AS SHOWN BELOW. REMOVE UPON COMPLETION OF WORK.</p> <div style="display: flex; justify-content: space-around;"> <div style="text-align: center;"> W20-1 48" X 48" PLACED 500' IN ADVANCE OF FLAGGER. </div> <div style="text-align: center;"> W20-7 A 48" X 48" PLACED 250' IN ADVANCE OF FLAGGER. </div> </div>
	2		#2 SIGN ONLY USED WHEN CONSTRUCTION LIMITS ARE 2 OR MORE MILES IN LENGTH. ROUND UP TO NEXT WHOLE NUMBER. (NO FRACTIONAL OR DECIMAL NUMBERS)	
	3		- PLACE INITIALLY AT THE CONSTRUCTION LIMITS AND SPACE 1 MILE APART THEREAFTER. - AT TEE INTERSECTIONS INSTALL INITIALLY 1/2 MILE FROM INTERSECTION AND SPACE 1 MILE APART THEREAFTER.	
	4		- THESE ARE FOR -Y- LINES THAT ARE "THROUGH" ROADWAYS. - DEAD END AND SUBDIVISION ROADS ARE NOT "THROUGH" ROADWAYS. - INSTALL 500' +/- FROM EACH -Y- LINE APPROACH AS SHOWN ABOVE. - FOR MULTIPLE -Y- LINES THAT ARE SEPARATED BY 0.25 MILES OR LESS, TREAT AS A SINGLE UNIT AND INSTALL WITHIN 500' OF EACH APPROACH. - A MAXIMUM OF 2 SIGN SETS PER MILE. DO NOT INSTALL WHEN -Y- LINES ARE WITHIN 0.5 MILES FROM "END ROAD WORK" SIGN. - FOR TEE INTERSECTIONS, INSTALL WITHIN 500' +/- OF THE INTERSECTION ALONG -L- LINE.	
	5		PLACE 500' FOLLOWING THE END OF CONSTRUCTION LIMITS OR AS SHOWN WHEN WORK ENDS AT A 3-WAY TEE INTERSECTION.	

THE ABOVE SIGNS ARE ALL THAT ARE REQUIRED FOR A CONTRACTOR TO BEGIN A RESURFACING CONTRACT. ANY ADDITIONAL SIGNS REQUESTED BY NCDOT DIVISIONS SHALL BE INSTALLED WITHIN 7 BUSINESS DAYS OF THE START OF CONTRACT WORK.

MAPS LESS THAN 2 MILES

FOR RESURFACING MAPS WITH CONSTRUCTION LIMITS LESS THAN 2 MILES IN LENGTH, NO STATIONARY SIGNS ARE REQUIRED. USE PORTABLE "ROAD UNDER CONSTRUCTION" OR "ROAD WORK AHEAD" SIGNS IN LIEU OF STATIONARY ADVANCE WARNINGS SIGNS.

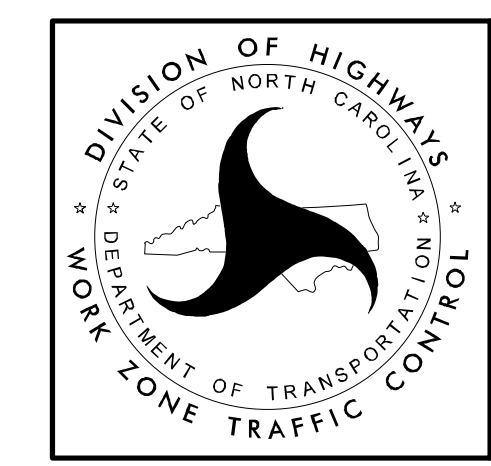

ADVANCE WARNING SIGNS FOR RURAL AND SUBURBAN 2-LANE ROADWAY RESURFACING

PROJECT NO.	SHEET NO.
HS2403C	8
50975.3.4	

SUMMARY OF QUANTITIES

PROJECT NO	COUNTY	MAP NO	ROUTE	DESCRIPTION	TYP NO	LANES	LANE TYPE	LENGTH	BEGIN MP	END MP	1231000000-E	1245000000-E	1575000000-E	1503000000-E	1881000000-E	1881000000-E
											SHOULDER BORROW	SHOULDER RECONSTRUCTION	ASPHALT BINDER FOR PLANT MIX	INTERMEDIATE, I19.0C	14" SINUSOIDAL RUMBLE	8" SINUSOIDAL RUMBLE
											MI	MI	TON	TON	LF	LF
HS2403C	Duplin	1	NC-111	FROM ONSLOW COUNTY LINE TO NC 41		2	2WU	8.42	0.00	8.42						
TOTAL FOR MAP NO. 1							8.42									
HS2403C	Duplin	2	NC-111	FROM BEULAVILLE CITY LIMITS TO SR 1703 CABIN ST	1,2	2	2WU	5.80	15.20	21.00	750	5.26	143	2,850	30,624	61,248
TOTAL FOR MAP NO. 2							5.80				750	5.26	143	2,850	30,624	61,248
HS2403C	Duplin	3	NC-111	FROM SR 1703 CABIN ST TO NC 11	2	2	2WU	4.38	21.00	25.38					23,127	46,253
TOTAL FOR MAP NO. 3							4.38								23,127	46,253
HS2403C	Duplin	4	NC-111	FROM NC 11 TO WAYNE COUNTY LINE	2	2	2WU	9.24	25.74	34.98					48,787	97,574
TOTAL FOR MAP NO. 4							9.24								48,787	97,574
TOTAL FOR PROJ NO. HS2403C							27.84				750	5.26	143	2,850	102,538	205,075
GRAND TOTAL							27.84				750	5.26	143	2,850	102,538	205,075

PROJECT NO.	SHEET NO.
HS2403C	9
50975.3.4	

THERMOPLASTIC AND PAINT QUANTITIES

PROJECT NO	COUNTY	MAP NO	ROUTE	DESCRIPTION	TYP NO	LANES	LANE TYPE	LENGTH	BEGIN MP	END MP	4413000000-E	4457000000-N	4688000000-E		4850000000-E
											WORK ZONE ADVANCE/GENERAL WARNING SIGNING	TEMPORARY TRAFFIC CONTROL	6" X 90 M WHITE THERMO	6" X90 M YELLOW THERMO	REMOVAL OF PAVEMENT MARKING LINES (4")
											SF	LS	LF	LF	LF
HS2403C	Duplin	1	NC-111	FROM ONSLOW COUNTY LINE TO NC 41		2	2WU	8.42	0.00	8.42	1,050	0.30	88,915	88,915	177,830
TOTAL FOR MAP NO. 1								8.42			1,050	0.30	88,915	88,915	177,830
HS2403C	Duplin	2	NC-111	FROM BEULAVILLE CITY LIMITS TO SR 1703 CABIN ST	1,2	2	2WU	5.8	15.20	21.00	650	0.21	61,248	44,500	
TOTAL FOR MAP NO. 2								5.8			650	0.21	61,248	44,500	
HS2403C	Duplin	3	NC-111	FROM SR 1703 CABIN ST TO NC 11	2	2	2WU	4.38	21.00	25.38	500	0.16	46,253	29,000	
TOTAL FOR MAP NO. 3								4.38			500	0.16	46,253	29,000	
HS2403C	Duplin	4	NC-111	FROM NC 11 TO WAYNE COUNTY LINE	2	2	2WU	9.24	25.74	34.98	1,050	0.33	97,574	87,174	
TOTAL FOR MAP NO. 4								9.24			1,050	0.33	97,574	87,174	
TOTAL FOR PROJ NO. HS2403C								27.84			3,250	1.00	293,990	249,589	177,830
											543,579				
GRAND TOTAL								27.84			3,250	1	293,990	249,589	177,830
											543,579				